



**FW-IOB-S-120VAC**

**Input/Output/Bypass Assembly**

Installation Instructions



The OutBack Power Systems FW-IOB-S-120VAC allows manual switching between the FX Series Inverter/Charger and a second AC source, facilitating maintenance and power continuity.

## About OutBack Power Systems

OutBack Power Systems is a leader in advanced energy conversion technology. Our products include true sine wave inverter/chargers, a maximum power point charge controller, system communication components, as well as breaker panels, breakers, accessories, and assembled systems.

## Notice of Copyright

FW-IOB-S-120VAC Installation Instructions  
Copyright © 2006 All rights reserved.

## Disclaimer

UNLESS SPECIFICALLY AGREED TO IN WRITING, OUTBACK POWER SYSTEMS:  
(a) MAKES NO WARRANTY AS TO THE ACCURACY, SUFFICIENCY OR SUITABILITY OF ANY TECHNICAL OR OTHER INFORMATION PROVIDED IN ITS MANUALS OR OTHER DOCUMENTATION.  
(b) ASSUMES NO RESPONSIBILITY OR LIABILITY FOR LOSS OR DAMAGE, WHETHER DIRECT, INDIRECT, CONSEQUENTIAL OR INCIDENTAL, WHICH MIGHT ARISE OUT OF THE USE OF SUCH INFORMATION. THE USE OF ANY SUCH INFORMATION WILL BE ENTIRELY AT THE USER'S RISK.

## Date and Revision

November 17, 2008 REV D

## Contact Information

OutBack Power Systems  
19009 62nd Ave. NE  
Arlington, WA 98223  
Phone (360) 435-6030 • Fax (360) 435-6019  
[www.outbackpower.com](http://www.outbackpower.com)

## Requirements and Warnings

The OutBack FW-IOB-S-120VAC is intended as a component for OutBack listed UL508A or UL1741 AC Industrial Control Panels.

It is intended for indoor use only.

Grounding Instructions – The frame of this enclosure should be connected to a grounded, permanent wiring system. The AC and DC circuits are not bonded to the FLEXware chassis. System grounding, when required by sections 690.41, 690.42, and 690.43 of the National Electric Code, ANSI/NFPA 70, is the responsibility of the installer. All installations should comply with all national and local codes and ordinances.

The equipment ground is marked with this symbol: 

# FW-IOB-S-120VAC Parts List

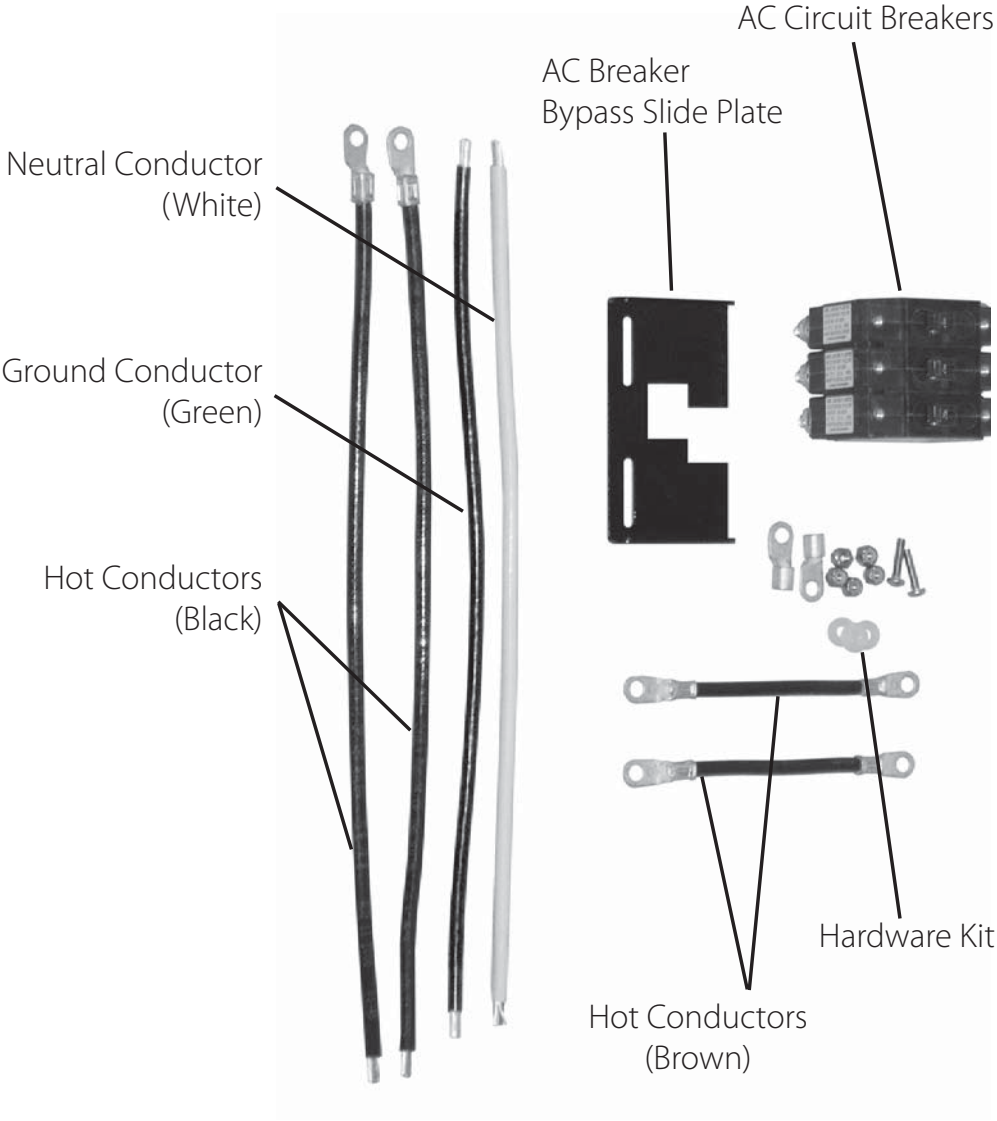
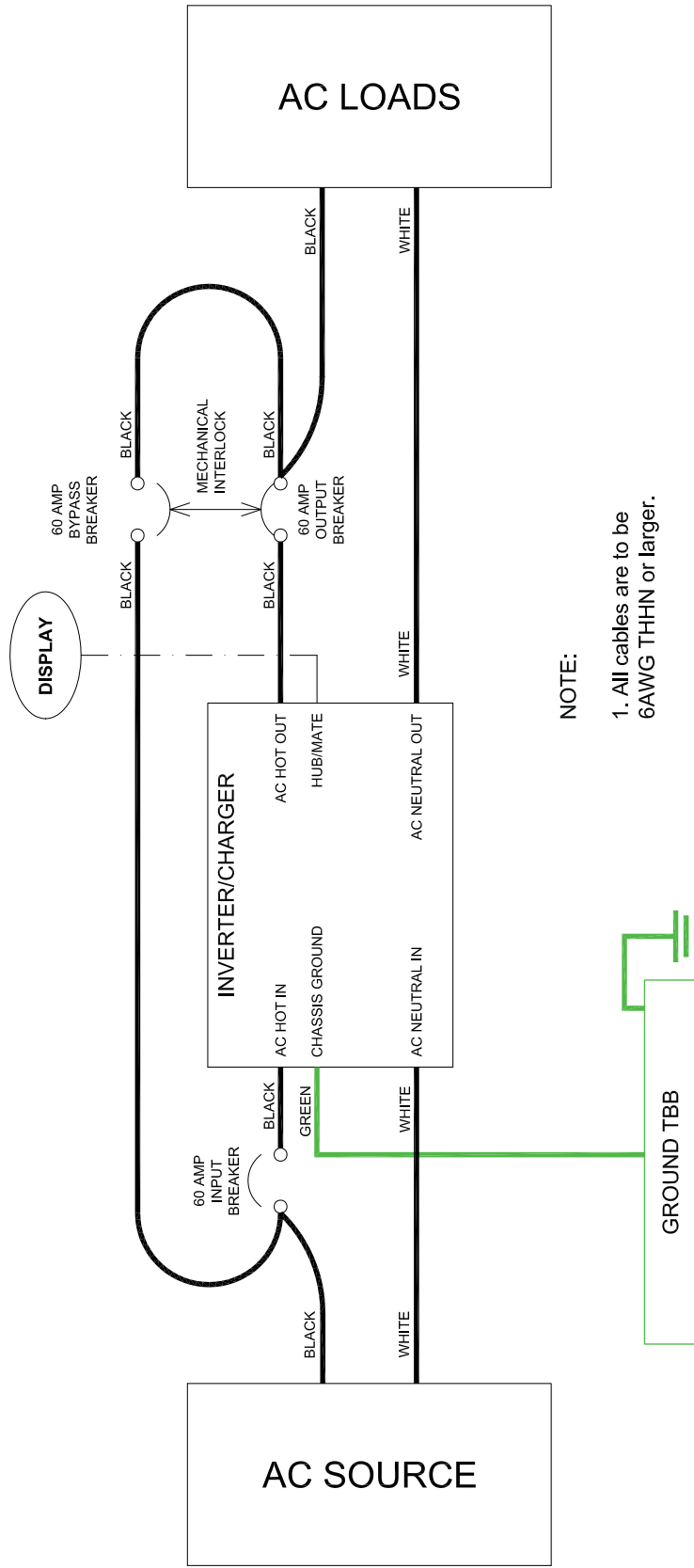

Figure 1: FW-IOB-S-120VAC



NOTE:

1. All cables are to be 6AWG THHN or larger.

Figure 2: Sample Wiring Diagram

## Installing FW-IOB-S-230VAC

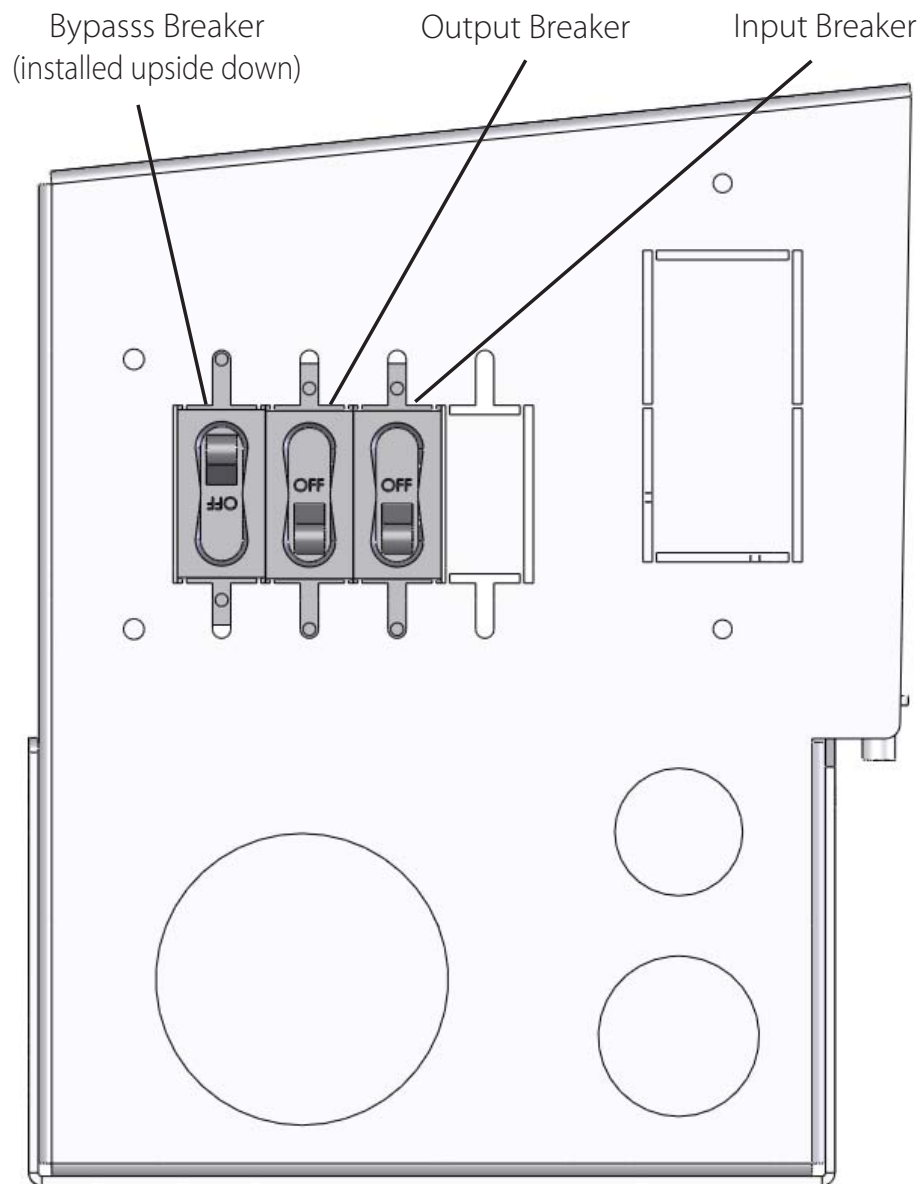

**Figure 3:** AC Breaker Installation

Installing AC Breakers in FLEXware 250:

- Remove the appropriate AC breaker knockouts from the AC side of chassis.
- Insert breakers into openings and secure with fasteners provided in the FW250 Hardware Kit.

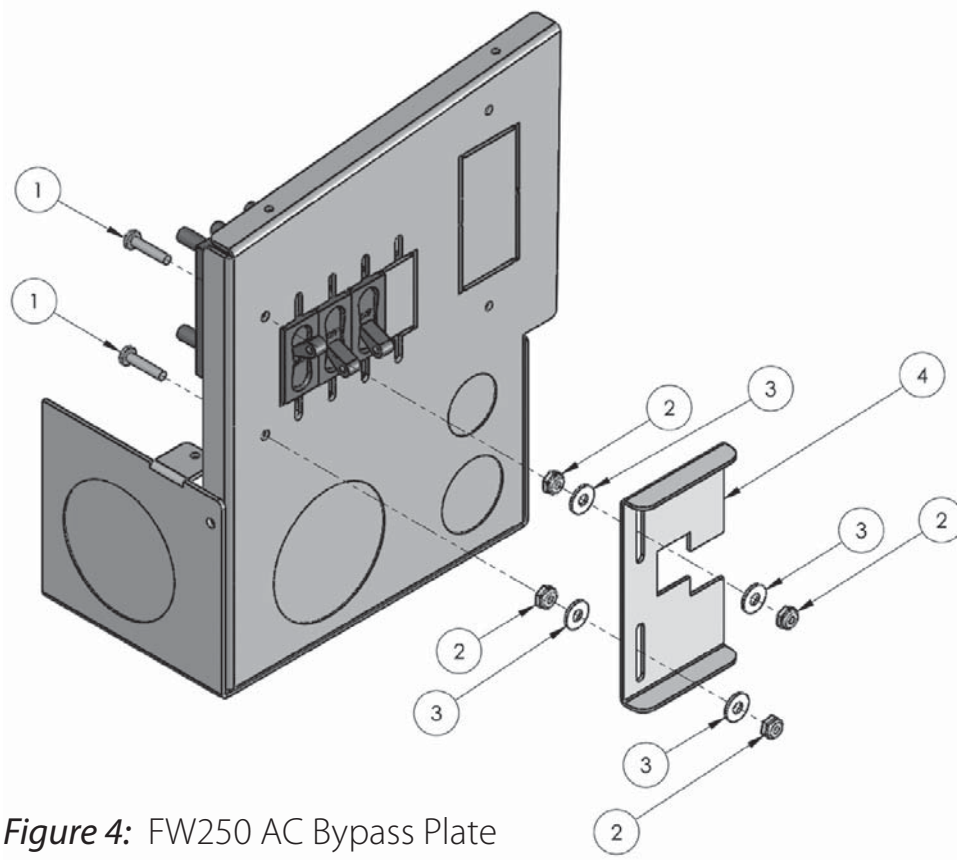

**Figure 4:** FW250 AC Bypass Plate Installation

**Parts:**

1. 8-32 X .75 Machine Screws (2)
2. 8-32 Nylock Nuts (4)
3. Nylon Washers (4)
4. FW250 AC Bypass Slide Plate (1)

**To Assemble:**

- A partial view of the FLEXware 250 chassis is shown for slide plate assembly clarity.
- Remove the necessary circuit breaker knockouts first.
- Install the AC Bypass Slide Plate as shown in the illustration.
- Do not overtighten the Nylock nuts. Overtightening can cause the AC Bypass Breaker Slide Plate to bind.



Corporate Office  
19009 62nd Avenue NE  
Arlington, WA USA  
(+1) 360-435-6030

[www.outbackpower.com](http://www.outbackpower.com)

European Sales Office  
C/ Castelló, 17  
08830 - Sant Boi de Llobregat  
BARCELONA, España  
Phone: +34.93.654.9568

900-0066-01-00 REV D